



STOP BY AND VISIT US!

www.buildingsforscience.com
(866) 808-5609



MODULAR & MOBILE

**TAKE THE LAB
TO THE SAMPLE**

FOOD SAFETY LABS

BOOTH #
426



For more info, contact: (886) 808-5609
www.buildingsforscience.com



ART'S WAY SCIENTIFIC
BUILDINGS FOR SCIENCE

Food Safety Summit 2017



**Fully Integrated, Fully Operational Modular/Mobile/Container
And Off-Site Laboratory Facilities**

For more info, contact: (886) 808-5609
www.buildingsforscience.com



Company History

- Natural transition from 20 year roots in agricultural confinement buildings to transgenic swine research buildings.
- Purchased in 2000 by Dr. Britz, DVM, to capitalize on historic market strength and build vivarium research buildings. Dr. Britz is a pioneer lab animal scientist and an industry leader in the development of modular research facilities.
- Strong business progression as Techspace into BSL-3 containment, public health, diagnostics, pharmaceuticals, food safety, energy and emerging technologies.
- Asset acquisition by Art's-Way Manufacturing in 2006 provides financial strength and 50 year quality and management history to the company.



ART'S WAY SCIENTIFIC
BUILDINGS FOR SCIENCE

The Leading Supplier of Modular Biomedical Research and Laboratory Buildings

The Modular Advantage

Consider Modular When These are Critical:

1. Time
2. Flexibility and SF Efficiency
3. Containment and Security
4. Complete Turnkey Solution
5. Minimal Site Disruption
6. Costs



For more info, contact: (886) 808-5609
www.buildingsforscience.com

Advantages of PMC

Greener. Faster. Smarter.

Faster

66% reported that project schedules are decreased (35% by four weeks or more).

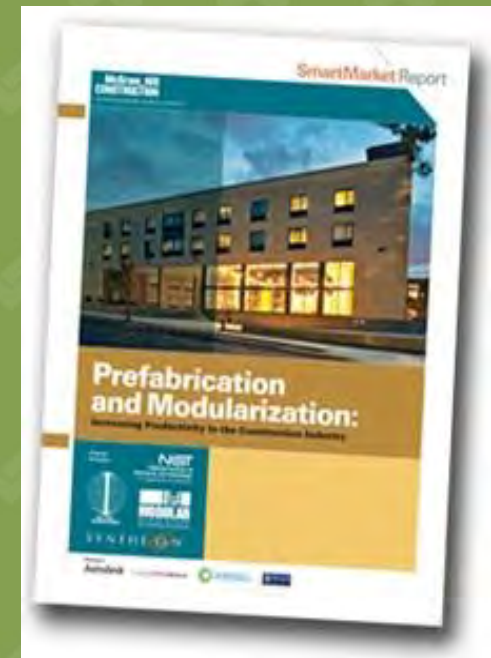



Construction/Manufacturing

- Highly controlled manufacturing processes, including materials and HVAC components.
- Progress not impacted by weather or site conditions.
- Engineering expertise supporting every step of the manufacturing process. Third-party inspections and certification of the complete manufacturing process and the product.
- Built to performance specifications aimed at supporting the people, equipment and processes housed in the laboratory.

Advantages of PMC

Greener. Faster. Smarter.

Greener

77% report that construction site waste is decreased (44% by 5% or more)

University of Alberta Hole School of Engineering Study – 44% lower carbon footprint vs. comparable site built project.

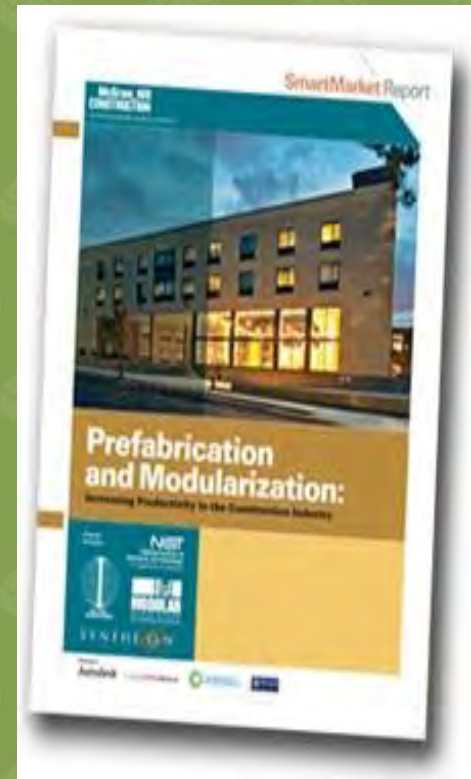

Advantages of PMC

Greener. Faster. Smarter.

Smarter

Cost Control - 65% reported that project budgets decreased (41% by 6% or more).

Safer - According to the [Safety Management in the Construction Industry SmartMarket Report](#), "Firms using prefabrication ... have significantly higher adoption levels of nearly all the safety practices measured in the survey."

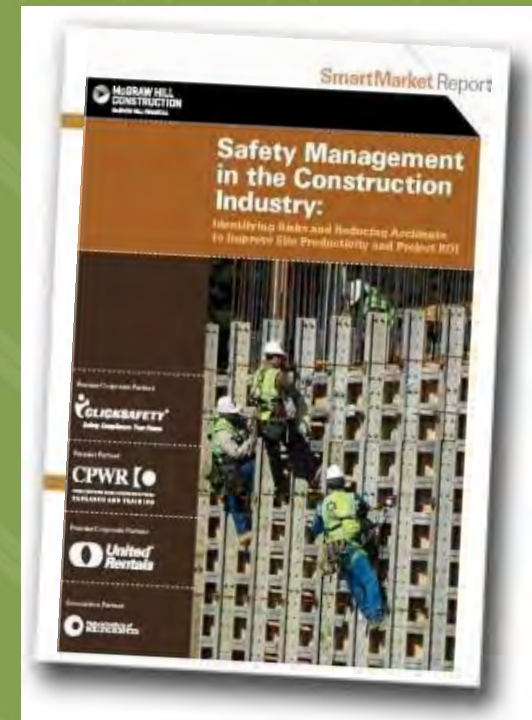



ART'S WAY SCIENTIFIC
BUILDINGS FOR SCIENCE

Simple to Complex – to fit your needs

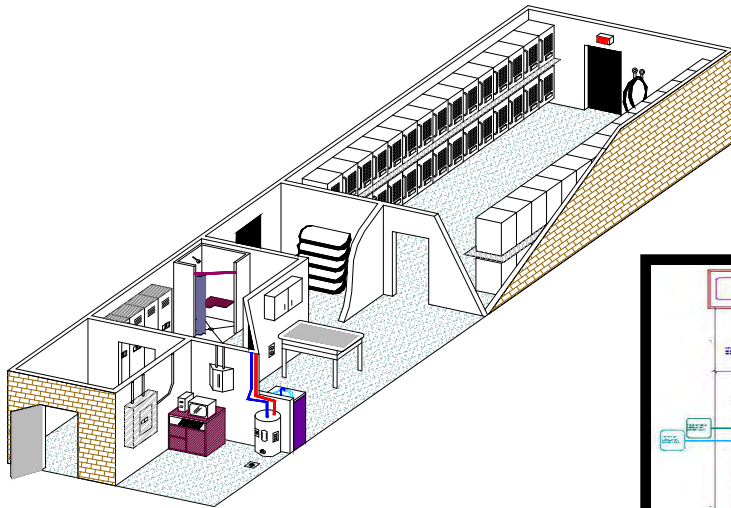

For more info, contact: (886) 808-5609
www.buildingsforscience.com



HVAC Design is critical



- Heating, ventilation, and air conditioning designed to meet specific needs including 100% fresh air supply with no recirculation at 15-20 air changes per hour.
- Optional HEPA filtration equipment on the supply, exhaust or both.



ART'S WAY SCIENTIFIC
BUILDINGS FOR SCIENCE

Equipment Integration

Fully operational facilities integrate the complete range of customer specified equipment:

- Sterilizers
- Decontamination
- Analytical equipment



For more info, contact: (886) 808-5609
www.buildingsforscience.com



ART'S WAY SCIENTIFIC

BUILDINGS FOR SCIENCE

Industry Equipment

Full Turnkey Solution Provider

We'll provide what you need from your preferred supplier or our alliance partners:

- Biosafety cabinetry
- Sterilizers
- Fume hoods
- Research cabinetry
- Decontamination systems
- Security Systems
- Laboratory Gasses
- Laboratory water systems



ART'S WAY SCIENTIFIC
BUILDINGS FOR SCIENCE

Flexible Installation Options

Site and Installation Alternatives are Limitless!

Buildings have been successfully and seamlessly installed:

- On the roof of existing research structures.
- Set apart as stand alone structures or;
- Attached alongside existing structures with matching facades.
- Within existing warehouse space.

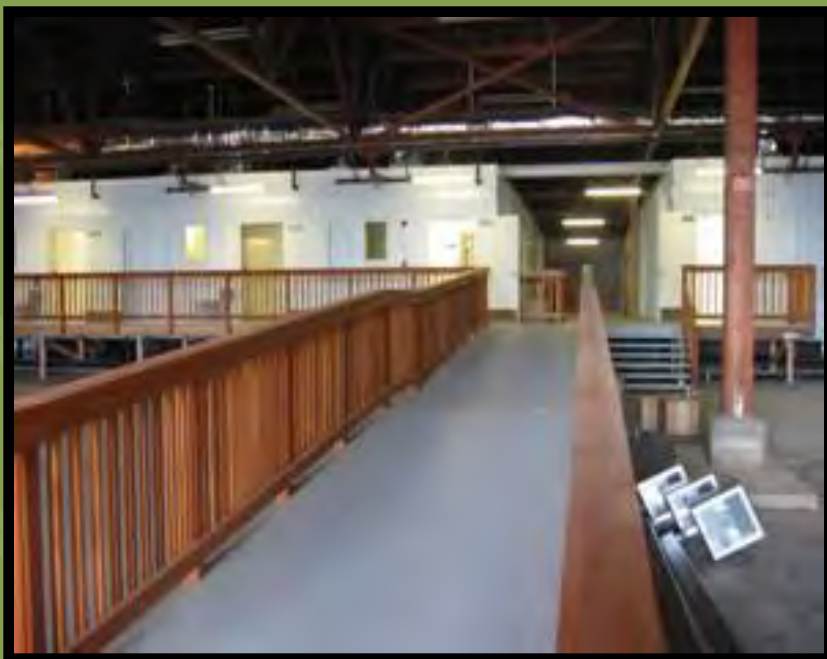

Expand available space, relocate, or easily re-outfit a building for different research needs, at a later date.



For more info, contact: (886) 808-5609
www.buildingsforscience.com



ART'S WAY SCIENTIFIC
BUILDINGS FOR SCIENCE

Project Tours



For more info, contact: (886) 808-5609
www.buildingsforscience.com



ART'S WAY SCIENTIFIC
BUILDINGS FOR SCIENCE

Temporary BSL-3 Laboratory



For more info, contact: (886) 808-5609
www.buildingsforscience.com

BSL-3 Public Health Laboratory

Building Basics:

2340 SF

Meets BMBL BSL-3 Guidelines

Key Equipment:

Biological Safety Cabinets

Fume Hood

Security Lockers

Automated Controls

Sealed Steam Sterilizer

X-Ray Scanner

Access Security and Perimeter Security

Glove Boxes

VHP Decontamination System

Autoclave

Emergency Generator

Laboratory Casework

Incubators



ART'S WAY SCIENTIFIC
BUILDINGS FOR SCIENCE

Interior

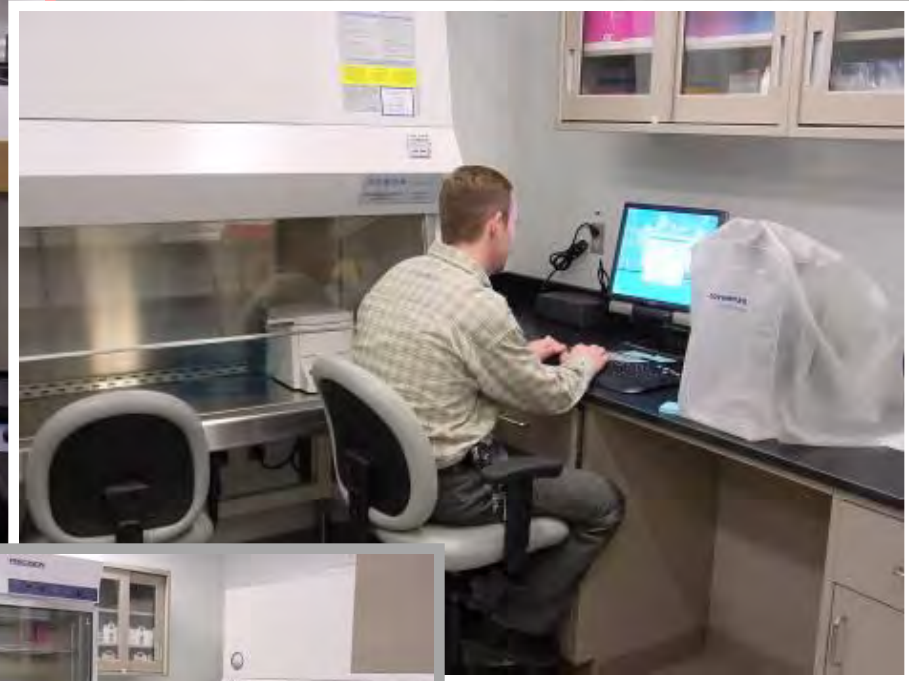

For more info, contact: (886) 808-5609
www.buildingsforscience.com



ART'S WAY SCIENTIFIC
BUILDINGS FOR SCIENCE

Public Health Triage Facility

Decatur Sorting and Triage



For more info, contact: (886) 808-5609
www.buildingsforscience.com

Critical Need



“The imminence of a possible event created a sense of urgency. We had an obligation to protect our people and our facility. Several years would have been too long.”

Karl Hoenes, Georgia Public Health Dept.



ART'S WAY SCIENTIFIC
BUILDINGS FOR SCIENCE

Nuclear Materials Quality Control Laboratory



For more info, contact: (886) 808-5609
www.buildingsforscience.com



ART'S WAY SCIENTIFIC

BUILDINGS FOR SCIENCE



Georgia Public Health Biocontainment Laboratory

For more info, contact: (886) 808-5609
www.buildingsforscience.com



Georgia Public Health

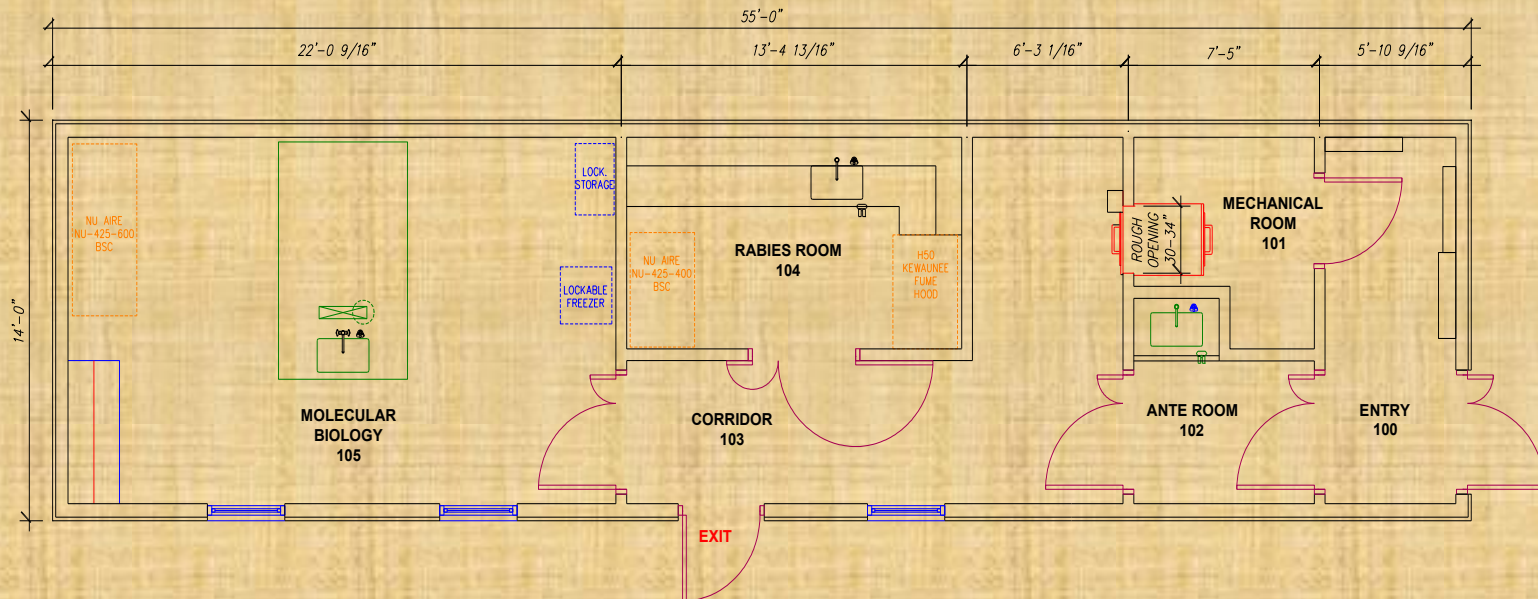



ART'S WAY SCIENTIFIC
BUILDINGS FOR SCIENCE



Built for future relocation.

For more info, contact: (886) 808-5609
www.buildingsforscience.com



ART'S WAY SCIENTIFIC
BUILDINGS FOR SCIENCE

Interior



For more info, contact: (886) 808-5609
www.buildingsforscience.com



ART'S WAY SCIENTIFIC
BUILDINGS FOR SCIENCE

Temporary Food Safety Laboratory

Art's Way Scientific facilities offer ultimate flexibility in design illustrated by this self-contained special food safety laboratory



For more info, contact: (886) 808-5609
www.buildingsforscience.com



ART'S WAY SCIENTIFIC

BUILDINGS FOR SCIENCE

Temporary Food Safety Laboratory

Fully integrated with autoclaves, workstations, and analytical equipment, this facility provides workflow efficiency for maximum sample throughput.



For more info, contact: (886) 808-5609
www.buildingsforscience.com



ART'S WAY SCIENTIFIC
BUILDINGS FOR SCIENCE

Project Tours: California Medical School



For more info, contact: (886) 808-5609
www.buildingsforscience.com



ART'S WAY SCIENTIFIC
BUILDINGS FOR SCIENCE

Project Tours: California Medical School

Project Description:

Rodent Housing Facility

- 24 modules for animal housing and procedure space totaling 20,350 square foot total.



For more info, contact: (886) 808-5609
www.buildingsforscience.com



ART'S WAY SCIENTIFIC
BUILDINGS FOR SCIENCE

Project Tours: California Medical School



For more info, contact: (886) 808-5609
www.buildingsforscience.com





ART'S WAY SCIENTIFIC
BUILDINGS FOR SCIENCE

Permanent Cancer Research Facility



For more info, contact: (886) 808-5609
www.buildingsforscience.com



ART'S WAY SCIENTIFIC
BUILDINGS FOR SCIENCE



For more info, contact: (886) 808-5609
www.buildingsforscience.com

Permanent Cancer Research Facility

Building Basics:

9000 SF two story building
5 labs on first floor
Offices on second floor

Meets BMBL BSL-3 Guidelines

Key Equipment:

Biological Safety Cabinets
Fume Hoods
Security Lockers
Automated Controls
Sealed Steam Sterilizer
Incubators

Liquid Nitrogen
Ultra Low Freezers
Autoclave
Emergency Generator
Laboratory Casework
Dark Room

Access Security and Perimeter Security



ART'S WAY SCIENTIFIC
BUILDINGS FOR SCIENCE

Mobile Response Laboratories

Various designs and sizes – Available through Alliance Partners

- Conditioned Laboratory Space
- PCR Rooms
- Office
- Procedure Rooms
- Air Lock Entry
- Locker/Bathrooms



For more info, contact: (886) 808-5609
www.buildingsforscience.com

Mobile





ART'S WAY SCIENTIFIC

BUILDINGS FOR SCIENCE

The Next Wave in Meeting Laboratory Space Needs: Permanent and Temporary Off Site Manufactured Buildings Mobile/Modular Laboratory Units



For more info, contact: (886) 808-5609
www.buildingsforscience.com











ART'S WAY SCIENTIFIC

BUILDINGS FOR SCIENCE



Contact:
Karl Arend, Project Manager
Art's Way Scientific, Inc.
563-380-1061
karend@buildingsforscience.com